

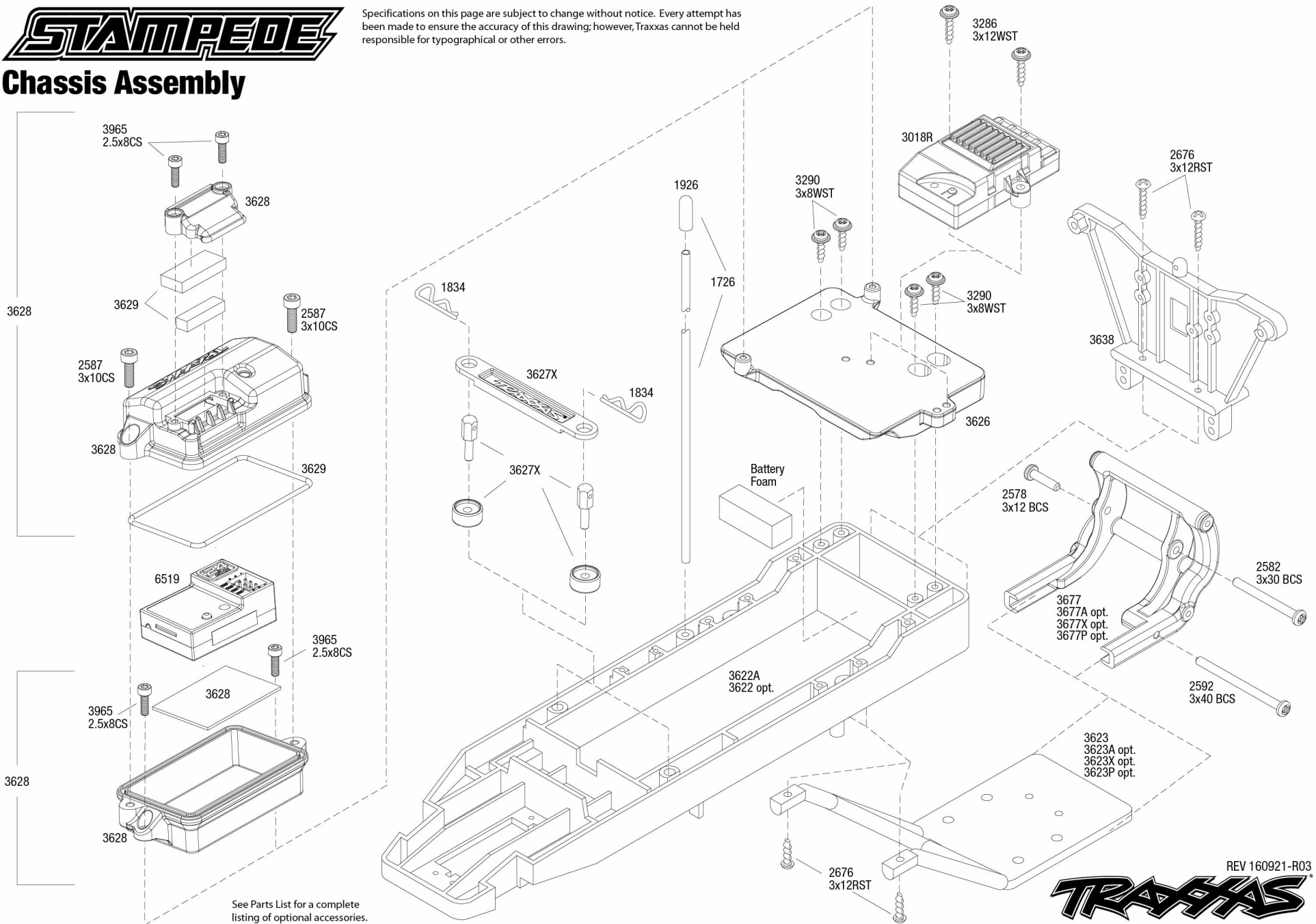

Chassis Assembly

Specifications on this page are subject to change without notice. Every attempt has been made to ensure the accuracy of this drawing; however, Traxxas cannot be held responsible for typographical or other errors.



See Parts List for a complete listing of optional accessories.

REV 160921-R03



4.ONL
3647
1747R opt.
1747G opt.
1747P opt.

3669
3669A opt.

3654

3186
3x12WMM
2742

2336
78mm

2742
3187
3x15WMM

1834
3x10WST
1834
3x10WST
3614

F-3758X
3758A opt.
3758T opt.
3758R opt.
3758P opt.
R-3757X
3757A opt.
3757T opt.
3757R opt.
3757P opt.

3767
3767A opt.
3767X opt.
3767G opt.
3767P opt.
E
3768
E
Limiter,
Rear only
F-1664
1664T opt.
R-2656
2656T opt.
3769
F-3765A
R-3766A
3768
1942
2742X
3768

Use #1666 silicone shock oil

1985
5x8x0.5PTW

3736
3636X opt.
3636A opt.
3636G opt.
3636P opt.

3642
3x12x5SS

2746
3x6MW
3760A
2660 opt.

1675
5x11x40B
5116 opt.

3637

3740
31.5mm
E

2754

2746

3642
3x12x5SS

2746
3x6MW

3641A
69mm

3642
3x12x5SS

2742

3288
3x15WST

3642
3x12x5SS

2746
3x6MW

3642
3x12x5SS

3760A
2660 opt.

2742

2573
4x15RM

3290
3x8WST

2056
2075 opt.

3622A
3622 opt.

3632
3632A opt.
3632X opt.
3632G opt.
3632P opt.

3739
24mm

3631

2746
3x6MW

3639

2746
3x6MW

3288
3x15WST

3642
3x12x5SS

2742

3641A
69mm

3642
3x12x5SS

2746
3x6MW

2754

3637

1675
5x11x40B
5116 opt.

3736
3636X opt.
3636A opt.
3636G opt.
3636P opt.

2735
2735P

3739
40mm

2530A
2530 opt.

2746
3x6MW

2754

3631

2563
3x15RM

3641A
69mm

2746
3x6MW

2754

3637

1675
5x11x40B
5116 opt.

3736
3636X opt.
3636A opt.
3636G opt.
3636P opt.

3654

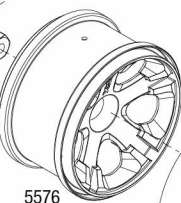

5576
5576A opt.
3673 opt.
3675 opt.

3671

3671

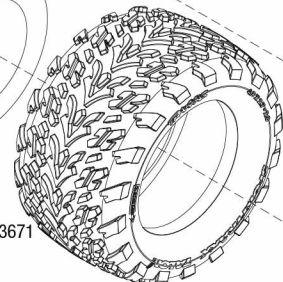

4.ONL
3647
1747R opt.
1747G opt.
1747P opt.

3739
40mm

2563
3x15RM

3631

3739
24mm

3740
31.5mm

E

1675
5x11x40B
5116 opt.

3736
3636X opt.
3636A opt.
3636G opt.
3636P opt.

1985
5x8x0.5PTW

2676
3x12RST

2746
3x6MW

1844

2676
3x12RST

2675
3x10RST

See Parts List for a complete listing of optional accessories.

Specifications on this page are subject to change without notice. Every attempt has been made to ensure the accuracy of this drawing; however, Traxxas cannot be held responsible for typographical or other errors.

Front Assembly



